

# State of Wyoming Corner Record

(In compliance with the *CORNER PERPETUATION AND FILING ACT*, Wyoming Statutes, 1997 Section 33-29-140 et. seq., and the Rules and Regulations of the Board of Professional Engineers and Professional Land Surveyors)

Reverse side of this form may be used if more space is needed.

Record of original survey and citation of source of historical information (if corner is lost or obliterated). Description of corner monumentation evidence found and/or monument and accessories established to perpetuate the location of this corner. Sketch of relative location of monument, accessories, and reference points with course and distance to adjacent corner(s) (if determined in this survey). Method and rationale for reestablishment of lost or obliterated corner.

**FOUND:** FOUND YELLOW SANDSTONE SET VERTICALLY NEAR FENCE CORNER—NO MARKS FOUND ON STONE — NOT ACCEPTED AS ORIGINAL CORNER FOUND 1/2 IN REBAR 55 FEET SOUTH OF STONE ACCEPTED AS PERPETUATING ORIGINAL CORNER POSITION. IT IS BELIEVED THAT STONE WAS SET AS A COUNTY ROAD STONE AND THAT REBAR WAS SET FROM STONE BY AN UNKOWN SURVEYOR

**SET:** SET 3 1/4 ALUMINUM CAP ON 3/4" X X30" REBAR STAMPED APPROPRIATELY AS SHOWN.NEXT TO EXISTING REBAR

- NOTE:**
- 1) THIS CORNER RECORDATION FORM IS BEING FILED TO CORRECT THE CORNER RECORDATION FORM SIGNED 8-30-07. THE SUBJECT MONUMENT HAS BEEN ACCEPTED AS PERPETUATING THE ORIGINAL CORNER LOCATION.
  - 2) THE CORNER HAS SINCE BEEN MONUMENTED AS SHOWN TO DOCUMENT THE PERPETUATED POSITION.
  - 3) FOR ADDITIONAL INFORMATION ON THIS CORNER SEE MAP OF SURVEY FOR T12N R60W AND A PORTION OF T13N R60W ON FILE AT THE LARAMIE COUNTY CLERK'S OFFICE IN SURVEY CABINET 4 MAP 29 AND BOOK2149 PAGE 59
  - 4) SEE ATTACHED PHOTOS FOR ADDITIONAL DETAILS



**Set Monument**



**Found Rebar**

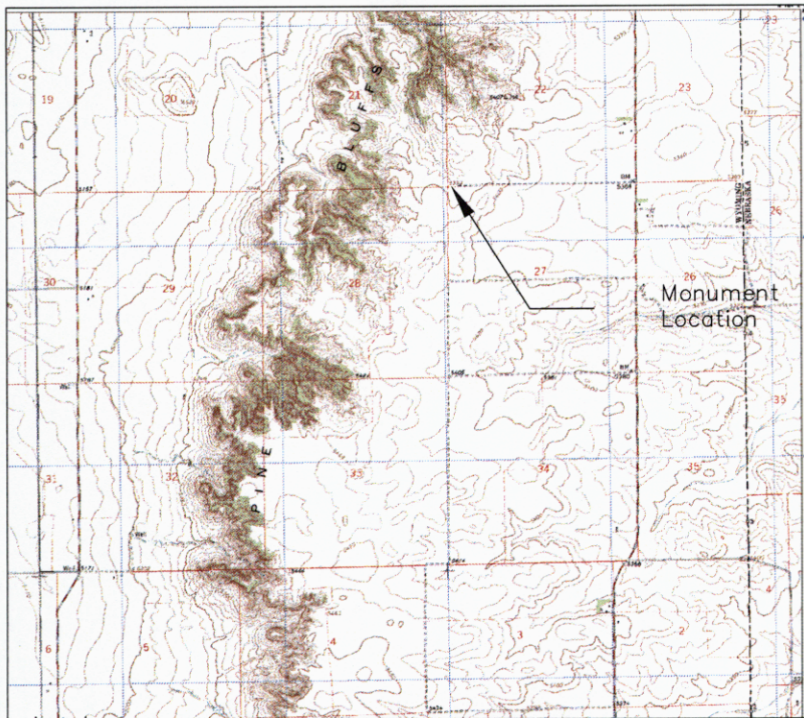

**Monument location**



**Found Stone**

Date of Field Work: 5/25/2007

Office Reference: 2655

## Cross Index Plat

1	2	3	4	5	6	7	8	9	10	11	12	13	14	15	16	17	18	19	20	21	22	23	24	25	
A	+	+	+	+	+	+	+	+	+	+	+	+	+	+	+	+	+	+	+	+	+	+	+	+	A
B	+	+	+	+	+	+	+	+	+	+	+	+	+	+	+	+	+	+	+	+	+	+	+	+	B
C	+	6	+	+	5	+	+	+	4	+	+	+	3	+	+	+	2	+	+	+	1	+	+	+	C
D	+	+	+	+	+	+	+	+	+	+	+	+	+	+	+	+	+	+	+	+	+	+	+	+	D
E	+	+	+	+	+	+	+	+	+	+	+	+	+	+	+	+	+	+	+	+	+	+	+	+	E
F	+	+	+	+	+	+	+	+	+	+	+	+	+	+	+	+	+	+	+	+	+	+	+	+	F
G	+	7	+	+	8	+	+	+	9	+	+	+	10	+	+	+	11	+	+	+	12	+	+	+	G
H	+	+	+	+	+	+	+	+	+	+	+	+	+	+	+	+	+	+	+	+	+	+	+	+	H
J	+	+	+	+	+	+	+	+	+	+	+	+	+	+	+	+	+	+	+	+	+	+	+	+	J
K	+	+	+	+	+	+	+	+	+	+	+	+	+	+	+	+	+	+	+	+	+	+	+	+	K
L	+	18	+	+	17	+	+	+	16	+	+	+	15	+	+	+	14	+	+	+	13	+	+	+	L
M	+	+	+	+	+	+	+	+	+	+	+	+	+	+	+	+	+	+	+	+	+	+	+	+	M
N	+	+	+	+	+	+	+	+	+	+	+	+	+	+	+	+	+	+	+	+	+	+	+	+	N
O	+	+	+	+	+	+	+	+	+	+	+	+	+	+	+	+	+	+	+	+	+	+	+	+	O
P	+	19	+	+	20	+	+	+	21	+	+	+	22	+	+	+	23	+	+	+	24	+	+	+	P
Q	+	+	+	+	+	+	+	+	+	+	+	+	+	+	+	+	+	+	+	+	+	+	+	+	Q
R	+	+	+	+	+	+	+	+	+	+	+	+	+	+	+	+	+	+	+	+	+	+	+	+	R
S	+	+	+	+	+	+	+	+	+	+	+	+	+	+	+	+	+	+	+	+	+	+	+	+	S
T	+	30	+	+	29	+	+	+	28	+	+	+	27	+	+	+	26	+	+	+	25	+	+	+	T
U	+	+	+	+	+	+	+	+	+	+	+	+	+	+	+	+	+	+	+	+	+	+	+	+	U
V	+	+	+	+	+	+	+	+	+	+	+	+	+	+	+	+	+	+	+	+	+	+	+	+	V
W	+	+	+	+	+	+	+	+	+	+	+	+	+	+	+	+	+	+	+	+	+	+	+	+	W
X	+	31	+	+	32	+	+	+	33	+	+	+	34	+	+	+	35	+	+	+	36	+	+	+	X
Y	+	+	+	+	+	+	+	+	+	+	+	+	+	+	+	+	+	+	+	+	+	+	+	+	Y
Z	+	+	+	+	+	+	+	+	+	+	+	+	+	+	+	+	+	+	+	+	+	+	+	+	Z
1	2	3	4	5	6	7	8	9	10	11	12	13	14	15	16	17	18	19	20	21	22	23	24	25	

Firm/Agency, Address

AVI P.C.  
2035 WESTLAND RD.  
CHEYENNE, WY. 82001

Telephone Number: 307-637-6017

This corner record was prepared by me or under my direction and supervision.

*SEAL & SIGNATURE*



Corner Name NW Section 27, T 13 N, R 60 W, 6TH P.M.  
County: LARAMIE Wyoming

Cross-Index No.: R-13

RECORDED 2/10/2010 AT 2:17 PM REC# 538989 BK# 2150 PG# 1270  
DEBRA K. LATHROP, CLERK OF LARAMIE COUNTY, WY PAGE 1 OF 3



View North



View East

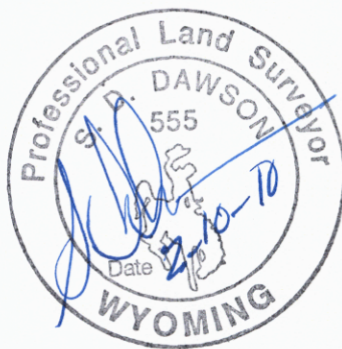

View South



View West



RECORDED 2/10/2010 AT 2:17 PM REC# 538989 BK# 2150 PG# 1271  
DEBRA K. LATHROP, CLERK OF LARAMIE COUNTY, WY PAGE 2 OF 3

Corner Name NW Section 27, T 13 N, R 60 W, 6TH P.M.



Set Monument View North



Set Monument View East

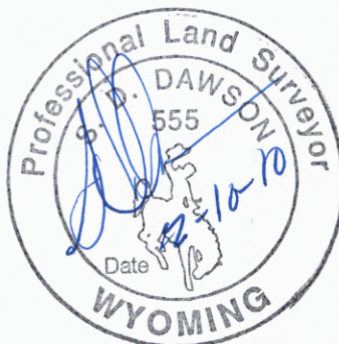

Set Monument View South



Set Monument View West



RECORDED 2/10/2010 AT 2:17 PM REC# 538989 BK# 2150 PG# 1272  
DEBRA K. LATHROP, CLERK OF LARAMIE COUNTY, WY PAGE 3 OF 3

Corner Name NW Section 27, T 13 N, R 60 W, 6TH P.M.